

# ENGLISH

## Contents

Power Supply .....	P.1
Tax Calculation .....	P.2
Connecting to a Computer .....	P.2
CAL Mode and PC Key Mode .....	P.3
Sending Data to a Computer .....	P.4
Auto Power-Off Function .....	P.5
User's Guide Addition For Windows® 98 Users .....	P.6
Important Safety Precautions .....	P.8
Calculation Example .....	P.155-158

## Power Supply

This calculator comes with a dual power source. The duration of alkaline battery depends entirely on individual usage. When the battery is exhausted, you can still use the solar cell to power the calculator.

- (Note: Do not attempt to change the battery by yourself. Have a Canon Service Center change the battery for you).
- Electromagnetic interference or electrostatic discharge may cause the display to malfunction or the contents of the memory to be lost or altered. Should this occur, use the tip of a ball point pen (or similar sharp object) to press the [RESET] button on the back of the calculator. After resetting, be sure to set the tax rate again.



3. You do not have to perform the [Specify a location] operation. Click [Next] to start the search for the driver.

**Important!**

If the USB driver is not located on your computer's hard disk, the installer will ask you for the Windows® 98 CD-ROM. Place the CD-ROM into your computer's drive, and then click [OK].



4. Click [Next]. This starts actual installation of the USB driver.
5. Click [Finish].



Windows® is a registered trademark of Microsoft® Corporation in the United States and other countries.

## Tax Calculation

**Store the Tax Rate** – Press [CA] [SET] and enter the tax rate figure, then press [CA] [SET] to store.

**Recall the Tax Rate** – Press [CA] [RECALL] to recall the current tax rate.

**Add Tax Key** – Used for adding the tax amount to the displayed figure.

**Deduct Tax Key** – Used for deducting the tax amount from the displayed figure.

## Connecting to a Computer

Use the USB cable that comes with the calculator to connect it to your computer.

- Connect the USB cable to your computer's USB port.
  - Make sure you connect directly to the computer's USB port. Proper operation may not be possible if you connect to a daisy chained USB device, USB port, etc.
- Connect the other end of the cable to the calculator's USB port.

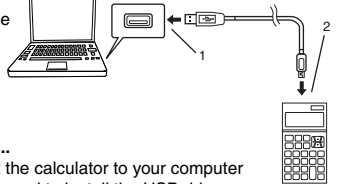

### What to do next...

After you connect the calculator to your computer the first time, you need to install the USB driver installer. Follow the instructions displayed by the installer to install the driver. With some computers, the USB installer should start up automatically when you connect the calculator.

## Important Safety Precautions

Note of the following safety precautions before using the calculator. Keep these safety precautions and operating instructions on hand for future reference.



### Serious malfunction

Never continue to use the calculator if it starts to smoke, emit a strange odor, or emit heat. Continued use of the calculator under such conditions creates the danger of fire and electric shock. Take the steps immediately.

- Disconnect the USB cable.
- Request servicing from your original retailer.

### USB cable

Misuse of the USB cable creates the danger of fire and electric shock. Be sure to observe the following precautions.

- Use only the USB cable that comes bundled with the calculator. Use of another USB cable creates the danger of fire and electric shock.
- Never place heavy objects on the USB cable, and never expose it to direct heat.
- Never modify or over bend the USB cable.
- Never twist or pull the USB cable.
- Should the USB cable or its plugs become seriously damaged, request servicing from your original retailer.
- Never touch the USB cable or its plugs when your hands are wet. Doing so creates the danger of electric shock.

### Important!

Never disconnect the USB cable while a calculator key operation is in progress.

If you experience problems with data transfer between the calculator and computer, try disconnecting and then reconnecting the USB cable.

## CAL Mode and PC Mode

This calculator has two modes: a CAL mode and a PC mode. The CAL mode is entered automatically whenever the calculator is not connected to a computer with the USB cable. If the calculator is in the PC mode when it is not connected, pressing any key causes it to enter the CAL mode. While the calculator is connected to a computer with the USB cable, pressing the [MODE] key toggles between the CAL mode and PC mode.

### CAL Mode

- The calculator performs normal calculator operations.
- You can send calculation results (display contents) to a computer.

### PC Mode

- Pressing a calculator key causes the corresponding code to the connected computer. This causes the corresponding value input or cursor movement on the computer screen.
- The calculators display shows "-----" while it is in the PC mode.

## Sending Data to a Computer

**CAL Mode**

In the CAL mode, you can send calculation results (display contents) to the connected computer by pressing the [SEND] key.

- The calculation result send operation takes some time to complete. Calculator keys are disabled while the send operation is in progress.
- You can send values only. 3-digit separator marks, indicators (M, =, etc.) are not sent.
- You cannot perform a send operation while the E (error) indicator is on the calculator display.
- The [SEND] key is disabled when the calculator is not connected to a computer.
- Pressing a computer keyboard key while a calculation result send operation is in progress can cause the computer input or its code to be inserted into the calculation result.

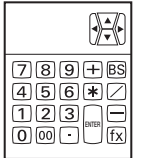

### PC Mode

This mode changes the calculator into a numeric keypad shown on the right. All other calculator keys are disabled in this mode.

### Important!

- Make sure to toggle **Number Lock** on before sending data in PC mode or by [SEND] key. Data will not be sent if Number Lock is off.
- When operating the calculator while it is connected to a computer, make sure you depress keys carefully and completely.
- If screen save of the computer activates, you can terminate the screen save and restore normal operation by pressing the following calculator keys.  
CAL Mode: [SEND] key  
PC Mode: Any key that is enabled in the PC mode.  
Note that you cannot recover from the computer's standby mode by pressing a calculator key.

### Do not dispose of the calculator by burning it

Throwing the calculator into a fire creates the risk of explosion, fire, and personal injury.



### USB cable

Misuse of the USB cable creates the danger of fire and electric shock. Be sure to observe the following precautions.

- Do not leave the USB cable near stoves or other sources of intense heat.
- When unplugging the USB cable, grasp the plug. Never pull on the cord itself.
- When plugging in the USB cable, make sure you insert it securely, as far as it will go.
- Whenever leaving the calculator unattended for long periods, be sure to disconnect the USB cable.

### Battery

Misuse of the battery can cause it to leak, which can damage nearby components, and create the risk of explosion, which can cause fire and personal injury. Be sure to observe the following precautions.

- Use only the battery type that is specified for this calculator.

### Heavy objects

Never place heavy objects on the calculator. Doing so can cause the object to lose its balance and fall, resulting in personal injury.

### Location

The following conditions create the risk of fire and electric shock. Avoid leaving the calculator in the locations like the ones described below.

- An area subject to high humidity and large amounts of dust
- In a food preparation area or other area subject to oil vapors
- Near a heater, on a heated carpet, in direct sunlight, in a car parked in the sun, or any other area subject to high temperatures

- Certain computer system configurations assign letters to the number keys of the main keyboard. When inputting values with the calculator, be sure to enable number input for your main computer keyboard. Otherwise, pressing number keys on the calculator will input the letters assigned to your computer keyboard number keys.
- Depending on the application you are using or the keyboard configuration of your computer, pressing a calculator key may input a character that is different from that marked on the key. In some cases, for example, pressing the [ ] key on the calculator inputs a comma instead of a decimal point.

## Automatic Power-Off Function

When the power is turned "ON" and none of the keys are pressed for more than **7 minutes**, the calculator turns off automatically to save power. Press [CA] key to re-start the calculator. "0" will appear in the display.

- Note that calculator draws power over the USB cable when connected to a computer, so power does not turn off automatically.

## Specifications

Power Source: Solar cell and alkaline battery (LR1130 x 1)  
Power supplied over the USB cable when connected to a computer.  
Usable temperature: 0°C to 40°C (30°F to 104°F)  
Dimensions: 135.5mm (L) x 103mm (W) x 34mm (H) (**LS-120PC**)  
5-11/32" (L) x 4-1/16" (W) x 1-11/32" (H)  
122mm (L) x 72mm (W) x 13mm (H) (**LS-12PC**)  
4-13/16" (L) x 2-27/32" (W) x 33/64" (H)  
Weight: 121.5g (4.29 oz) (**LS-120PC**) / 66g (2.33 oz) (**LS-12PC**)  
Bundled Accessories: USB Cable  
(Subject to change without notice)

## User's Guide Addition For Windows® 98 Users

You need to install a USB driver on a computer to which you connect the calculator.

**Note:** It is recommended to install the device after Windows® is completely loaded. Device may not work properly the 1st time if installed before Windows® is loaded.

The following installation guide assumes the following system setup.

- Windows® is located on the C: drive.
- Windows® 98 is installed in a folder named Windows®.

Connecting the calculator to your computer causes the dialog box shown on the right to appear.



Perform the following steps to install the driver.

1. Click the [Next] button.



2. Click the [Next] button.

